

Mating PCB detail

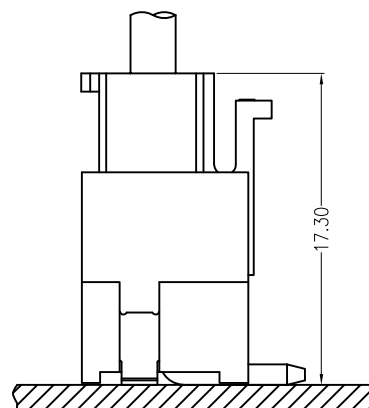

Assembly Layout

**主要技术参数 Main Specifications**

- 线数 (Poles): 02 to 16
- 接触电阻 (Contact resistance):  $\leq 20m\Omega$
- 绝缘电阻 (Insulation resistance):  $\geq 1000M\Omega$
- 额定电压 (Rated voltage): 250V AC DC
- 额定电流 (Rated current): 7.0A AC DC
- 耐电压 (Withstand Voltage): 1500V AC/minute
- 温度范围 (Temperature Range):  $-25^{\circ}C \sim +105^{\circ}C$

Circuits	Dimensions (mm)		
	DIM. A	DIM. B	DIM. C
02	3.96	11.88	8.60
03	7.92	15.84	12.56
04	11.88	19.80	16.52
05	15.84	23.76	20.48
06	19.80	27.72	24.44
07	23.76	31.68	28.40
08	27.72	35.64	32.36
09	31.68	39.60	36.32
10	35.64	43.56	40.28
11	39.60	47.52	44.24
12	43.56	51.48	48.20
13	47.52	55.44	52.16
14	51.48	59.40	56.12
15	55.44	63.36	60.08
16	59.40	67.32	64.04

一般公差  
TOLERANCES  
X. ±0.40 .XX ±0.20  
.X ±0.30 .XXX ±0.10  
ANGLES ±2°

检验尺寸标示  
SYMBOLS  $\odot$   $\ominus$  INDICATE  
CLASSIFICATION DIMENSION

$\odot$  MARK IS CRITICAL DIM.  
 $\ominus$  MARK IS MAJOR DIM.

表面处理 (FINISH)

深圳市宏利电子有限公司  
Shenzhen Holy Electronic Co.,Ltd

工程图号: VH396LB-nP  
制图 (DR): '2016/6/16  
品名: VH3.96-nP 立贴  
审核 (CHKD):

TITLE: VH3.96mm Pitch LB FOR SMT CONN  
核准 (APPD): Rigo Lu

比例 (SCALE): 1:1  
单位 (UNITS): mm  
张数 (SHEET): 1 OF 1  
尺寸 (SIZE): A4  
REV: 0

修订 REV	修改摘要 REVISION DESCRIPTION	日期 DATE	签名 SIGNATURE